

CABIN AIR FILTER – INSTALLATION INSTRUCTIONS

Part No.: **CAF1766 / CAF7766**

Est. Installation Time: **less than 10 min.**

Lexus (2004-11), Mazda MPV (2000-03), Mitsubishi (2004-10), Subaru (2005-10) , Toyota (2004-11),

1. Cabin air filter is located behind the glove compartment.
2. Disconnect the glove box damper or right side - Fig. 1 (some application you need to remove the two pins installed on the upper part inside of the glove box)
3. Push each side of the glove box to disconnect the claws. See . Fig 2 and allow the glove compartment to swing freely down towards the floorboard on its bottom hinge. This will allow access to the cabin filter tray.
4. Locate the cabin filter plastic cover and unlock it by pressing inward on the left and right side tabs and remove by pulling the tray straight out towards you. (Fig 3)
5. Remove the old filter from the tray.
6. Put the new filter in the filter tray with the air flow arrows pointing down (Fig 4)
7. Put the tray with the clean filter back into the vehicle by sliding back into position. Make sure that the filter tray is completely seated.
8. Install the filter housing cover back
9. Put the glove compartment back into position by raising it in place and pushing in on both sides to re-engage the glove compartment stops.
10. If your vehicle has a stop rod on the right hand side of the glove compartment, reconnect it at this time by hooking it back to the right hand side of the glove compartment
11. Close glove compartment.

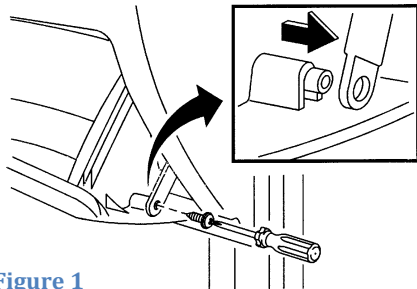

Figure 1

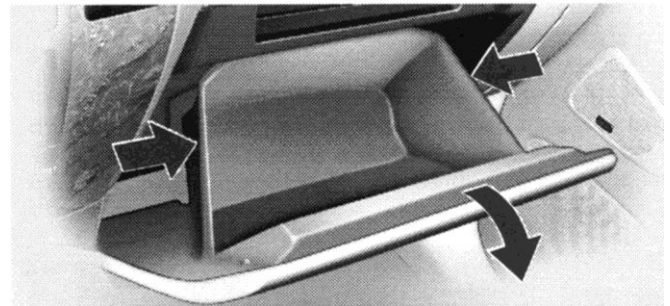

Figure 2



Figure 3



Figure 4